



FITTING INSTRUCTIONS FOR CP0384BL
AERO CRASH PROTECTORS
DUCATI SCRAMBLER 2015-



Picture A



Picture B

THIS KIT CONTAINS THE ITEMS PICTURED AND LABELLED BELOW.
DO NOT PROCEED UNTIL YOU ARE SURE ALL PARTS ARE PRESENT.

Please note that the way the kit is packed does not necessarily represent the way of mounting to the bike.

THE PARTS SHOWN MAY BE REPRESENTATIVE ONLY (FOR CLARITY OF INSTRUCTIONS ONLY).

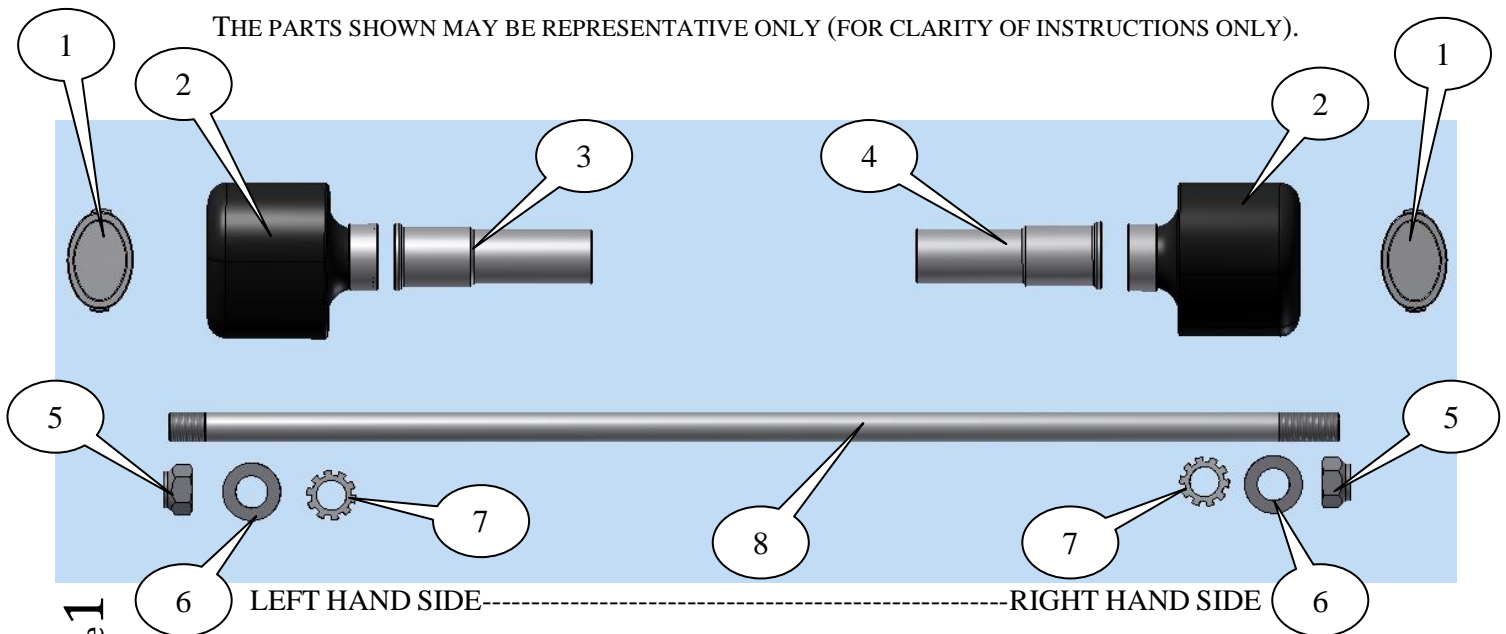



LEGEND

- ITEM 1 = CRASH PROTECTOR CAPS (BC0002) (x2).
 ITEM 2 = CRASH PROTECTOR (B0431 with CS340) (x2).
 ITEM 3 = LEFT HAND SIDE SPACER (S0858) (82mm long) (x1).
 ITEM 4 = RIGHT HAND SIDE SPACER (S0859) (77mm long) (x1).
 ITEM 5 = M12 NYLOC NUTS (x2).
 ITEM 6 = M12 WASHERS (x2).
 ITEM 7 = LOCK-WASHERS (LW0001) (x2).
 ITEM 8 = ENGINE BAR (M12x485mm LONG) (EB0082) (x1).

Please note that in cases where kits are packed with rubber washers holding the components onto the bolt – *the rubber washers should be thrown away!*

TOOLS REQUIRED

- Socket set to include 15 & 2x19mm sockets and wrench.
 - 8mm A/F Allen key.
 - Soft mallet.
- Torque wrench (up to 40Nm).



GENERAL TORQUE SETTINGS

- M4 BOLT = 8Nm
 M5 BOLT = 12Nm
 M6 BOLT = 15Nm
 M8 BOLT = 20Nm
 M10 BOLT = 40Nm
 M12 NYLOC NUT = 40Nm



PICTURE 1



PICTURE 2



PICTURE 3



FITTING INSTRUCTIONS

- From the right hand side undo and remove the nut arrowed in picture 1.
- Take R&G replacement stainless steel engine bar (item 8) and use it to push out the original engine bolt shown in picture 1 (if the bolt is difficult to remove, use a soft hammer to help knock it through). Please leave equal amounts protruding from either side. **Please ensure the original engine spacers remain in place.**

Near side (left side as you sit on bike)

- Place the longer spacer (item 3=82mm long) over the exposed end of the engine bar on the left hand side with the larger diameter away from the bike frame as shown in picture 2.
- Place one of the crash protectors (item 2) over the exposed end of engine bar on the left hand side, so it sits against the spacer just fitted.
- Place one of the shake proof washers (item 7) over the exposed end of the engine bar (so it goes into the counter-bore).
- Place one of the plain M12 washers (item 6) over the exposed end of the engine bar (so it sits against the shake proof washer).
- Fit one of the M12 nyloc nuts (item 5) onto the thread (please ensure the nut is fully engaged).

Off side (right side as you sit on bike)

- Place the remaining shorter spacer (item 4=77mm long) over the exposed end of the engine bar on the right hand side with the larger diameter away from the bike frame as shown in picture 3.
- Place the remaining crash protector (item 2) over the exposed end of engine bar on the right hand side, so it sits against the spacer just fitted.
- Place the remaining shake proof washer (item 7) over the exposed end of the engine bar (so it goes into the counter-bore).
- Place the remaining plain M12 washer (item 6) over the exposed end of the engine bar (so it sits against the shake proof washer).
- Fit the remaining M12 nyloc nuts (item 5) onto the thread (please ensure the nut is fully engaged).
- Finally tighten the nuts until you feel some compression from inside the protector using two 19mm sockets and wrenches. **PLEASE NOTE THE CRASH PROTECTOR MUST BE POSITIONED AS IN PICTURE 'C' WITH BIGGER END TOWARD FRONT OF BIKE.** Turn a little more so that you feel the compression increase slightly. Then apply a quarter turn. Do not over tighten as damage can occur to the bike. Do not exceed 40Nm of torque.
- Fit the crash protector caps (item 1) as shown in pictures A and B.

ISSUE 1 03/03/2015 (NSY)

Digital copies of these instructions are available to download from www.rg-racing.com

CONSUMER NOTICE

The catalogue description and any exhibition of samples are only broad indications of the Products and R&G may make design changes which do not diminish their performance or visual appeal and supplying them in such state shall conform to the order. The Buyer acknowledges no representation or warranty (other than as to title) has been given or will apply to the Products other than those in R&G's order or confirmation and the Buyer confirms it has chosen the Products as being of merchantable quality

R&G Racing

Unit 1, Shelley's Lane, East Worldham, Alton, Hampshire, GU34 3AQ

Tel: +44 (0)1420 89007 Fax: +44 (0)1420 87301 www.rg-racing.com Email: info@rg-racing.com



and suitable for its particular purposes. Where R&G fits the Products or undertakes other services it shall exercise reasonable skill and care and rectify any fault free of charge unless the workmanship has been disturbed. The Buyer is responsible for ensuring that the warranty on the motorcycle is not affected by the fitting of the Products. On return of any defective Products R&G shall at its option either supply a replacement or refund the purchase money but shall not be liable if the Products have been modified or used or maintained otherwise than in accordance with R&G's or manufacturer's instructions and good engineering practice or if the defect arises from accident or neglect. Other than identified above and subject to R&G not limiting its liability for causing death and personal injury, it shall not be liable for indirect or consequential loss and otherwise its liability shall be limited to the amounts paid by the Buyer for the Products or the fitting or service concerned. These terms do not affect the Buyer's statutory rights.

R&G RACING RETURNS POLICY (NON-FAULTY GOODS)

Returns must be pre-authorized (if not pre-authorized the return will be rejected). Goods may only be returned direct to us if they were purchased direct from us (customer must prove if necessary). Otherwise to be returned to original vendor. Goods must be in re-sellable condition, in the opinion of R&G Racing. All returns are subject to a 25% restocking and handling fee (25% of the gross value exc. P&P – at the prevailing price at time of purchase). The customer must pay any and all carriage charges. No returns of discontinued products, unless within 14 days of purchase. This policy does not affect your statutory rights and does not refer to faulty goods.



INSTRUCTIONS DE MONTAGE POUR CP0384BL
PROTECTIONS LATERALES
DUCATI SCRAMBLER 2015-



Photo A

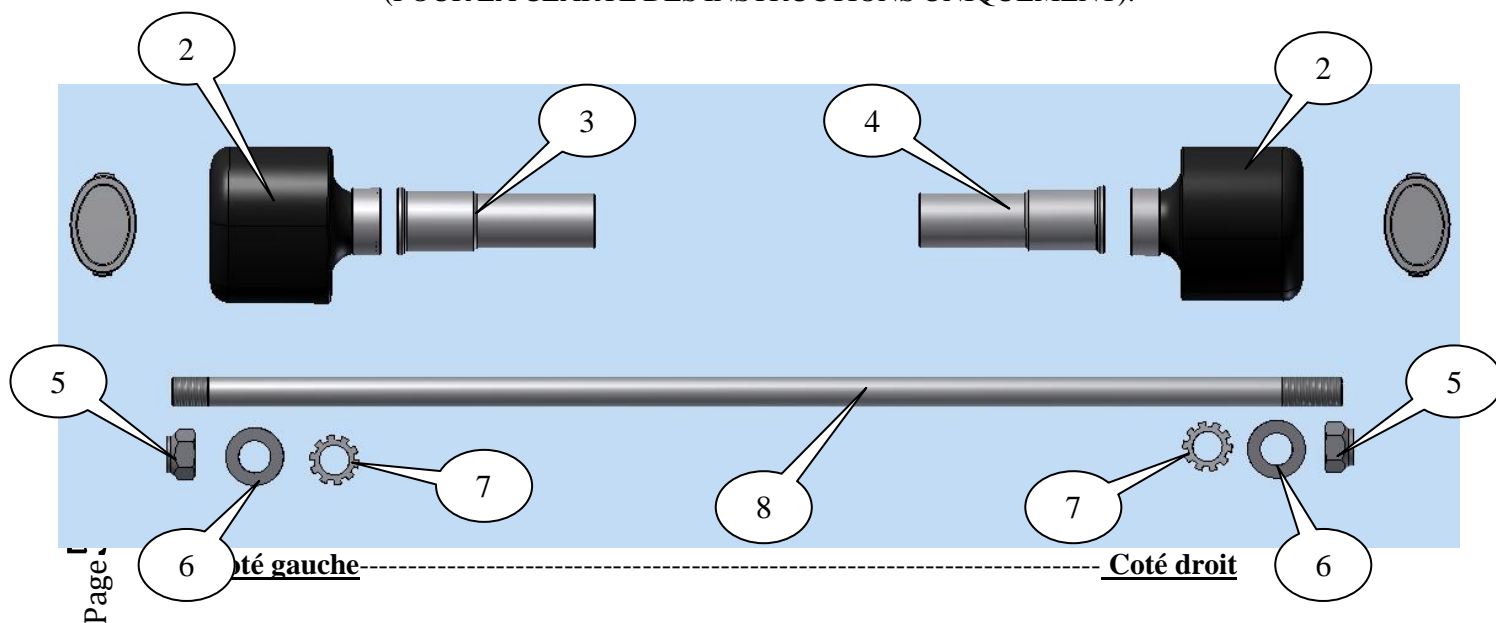

Photo B

LE KIT CONTIENT LES ARTICLES EXPOSES CI-DESSOUS, VERIFIER QUE TOUTES LES PIECES SOIENT PRESENTES AVANT DE PROCEDER AU MONTAGE.

LA FAÇON DONT LE KIT EST EMBALLE NE CORRESPOND PAS FORCLEMENT A LA FAÇON DE MONTER LES PIECES SUR LA MOTO.

LES PARTIES PRESENTEES PEUVENT ETRE UNIQUEMENT REPRESENTATIVES (POUR LA CLARTE DES INSTRUCTIONS UNIQUEMENT).



Page:



LEGENDE

ARTICLE 1 = CAPUCHONS DE PROTECTION CRASH (BC0002) (x2).

ARTICLE 2 = PROTECTIONS CRASH (B0431 avec CS340) (x2).

ARTICLE 3 = ENTRETOISE GAUCHE (S0858) (82mm de long) (x1).

ARTICLE 4 = ENTRETOISE DROITE (S0859) (77mm de long) (x1).

ARTICLE 5 = M12 ECROUS (x2).

ARTICLE 6 = M12 RONDELLES (x2).

ARTICLE 7 = RONDELLES DE BLOCAGE (LW0001) (x2).

ARTICLE 8 = AXE MOTEUR (M12x485mm de long) (EB0082) (x1).

Notez que si les kits sont emballés avec des rondelles en caoutchouc servant à tenir les composants, *ces rondelles doivent être jetées!*

OUTILS REQUIS

- Clés à douille 15 & 2x19mm.
 - Clé Allen 8mm.
 - Petit maillet.
- Clé dynamométrique (à 40Nm).

Arrière de la moto

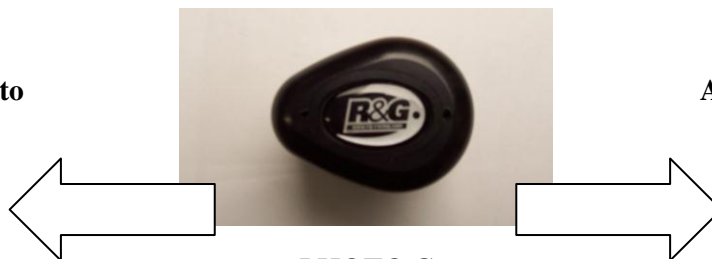

Avant moto

PHOTO C

COUPLES DE SERRAGE

M4 BOULON = 8Nm

M5 BOULON = 12Nm

M6 BOULON = 15Nm

M8 BOULON = 20Nm

M10 BOULON = 40Nm

M12 ECROU = 40Nm



Unit 1, Shelley's Lane, East Worldham, Alton, Hampshire, GU34 3AQ

Tel: +44 (0)1420 89007 Fax: +44 (0)1420 87301 www.rg-racing.com Email: info@rg-racing.com



PHOTO 1

PHOTO 2

PHOTO 3

INSTRUCTIONS DE MONTAGE

- Du coté droit de la moto, enlever l'écrou, voir photo 1.
- Prendre l'axe moteur R&G (article 8) et utilisez le pour ex le boulon moteur d'origine indiqué sur la photo 1 (Si le boulon est difficile à enlever, utilisez un petit maillet pour aider à le sortir). Laissez des longueurs identiques dépasser de chaque coté. **Veillez à ce que les entretoises moteur d'origine restent en place.**

Coté gauche assis sur la moto

- Placer l'entretoise (article 3=82mm de long) sur l'extrémité de l'axe moteur du coté gauche avec le diamètre le plus large espacé de la moto, voir photo 2.
- Placer la protection crash (article 2) sur l'extrémité de l'axe moteur du coté gauche, de façon à ce qu'elle se place contre l'entretoise tout juste insérée.
- Placer une des rondelles anti vibration (article 7) sur l'extrémité de l'axe moteur (de façon à ce qu'elle se place dans le contre alésage).
- Placer une des rondelles M12 (article 6) sur l'extrémité de l'axe moteur (de façon à ce qu'elle se place contre la rondelle anti vibration).
- Insérez un des écrous M12 (article 5) sur le filetage (veiller à ce que l'écrou soit complètement engagé).

Coté gauche assis sur la moto

- Placer l'entretoise courte (article 4=77mm de long) sur l'extrémité de l'axe moteur du coté droit avec le diamètre le plus large espacé de la moto, voir photo 3.
- Placer la protection crash restante (article 2) sur l'extrémité de l'axe moteur du coté droit, de façon à ce qu'elle se place contre l'entretoise tout juste insérée.
- Placer la rondelle anti vibration restante (article 7) sur l'extrémité de l'axe moteur (de façon à ce qu'elle se place dans le contre alésage).
- Placer la rondelle M12 restante (article 6) sur l'extrémité de l'axe moteur (de façon à ce qu'elle se place contre la rondelle anti vibration).
- Insérer l'écrou M12 restante (article 5) sur le filetage (Veiller à ce que l'écrou soit complètement).
- Serrer les écrous de la protection jusqu'à ce que vous sentiez une compression de l'intérieur de la protection avec une clé de 19mm. **LA PROTECTION DOIT ETRE POSITIONNEE COMME EN "C" AVEC LE COTE ARRONDI LE PLUS GROS EN DIRECTION DE L'AVANT DE LA MOTO.** Tourner un peu plus afin d'accentuer légèrement la compression. Faire un quart de tour. Pas plus de 40 Nm de couple - Ne pas trop serrer, au risque d'abîmer les composants.
- Placez les capuchons de protection (article 1) comme sur les photos A et B.

ISSUE 1 03/03/2015 (NSY)

Ces instructions sont disponibles au téléchargement sur www.rg-racing.com



CONSUMER NOTICE

The catalogue description and any exhibition of samples are only broad indications of the Products and R&G may make design changes which do not diminish their performance or visual appeal and supplying them in such state shall conform to the order. The Buyer acknowledges no representation or warranty (other than as to title) has been given or will apply to the Products other than those in R&G's order or confirmation and the Buyer confirms it has chosen the Products as being of merchantable quality and suitable for its particular purposes. Where R&G fits the Products or undertakes other services it shall exercise reasonable skill and care and rectify any fault free of charge unless the workmanship has been disturbed. The Buyer is responsible for ensuring that the warranty on the motorcycle is not affected by the fitting of the Products. On return of any defective Products R&G shall at its option either supply a replacement or refund the purchase money but shall not be liable if the Products have been modified or used or maintained otherwise than in accordance with R&G's or manufacturer's instructions and good engineering practice or if the defect arises from accident or neglect. Other than identified above and subject to R&G not limiting its liability for causing death and personal injury, it shall not be liable for indirect or consequential loss and otherwise its liability shall be limited to the amounts paid by the Buyer for the Products or the fitting or service concerned. These terms do not affect the Buyer's statutory rights.

R&G RACING RETURNS POLICY (NON-FAULTY GOODS)

Returns must be pre-authorized (if not pre-authorized the return will be rejected). Goods may only be returned direct to us if they were purchased direct from us (customer must prove if necessary). Otherwise to be returned to original vendor. Goods must be in re-sellable condition, in the opinion of R&G Racing. All returns are subject to a 25% restocking and handling fee (25% of the gross value exc. P&P – at the prevailing price at time of purchase). The customer must pay any and all carriage charges. No returns of discontinued products, unless within 14 days of purchase. This policy does not affect your statutory rights and does not refer to faulty goods.